

- Notes**
- All drawings are to be read in conjunction with all relevant Specifications, Bills of Quantities, Architectural, Services and Engineering drawings.
 - Any discrepancies between these documents shall be brought to the attention of the Engineer.
 - All dimensions are in millimetres unless noted otherwise.
 - All levels are in metres related Ordnance Datum Malin Head.
 - Drawings are not to be scaled.

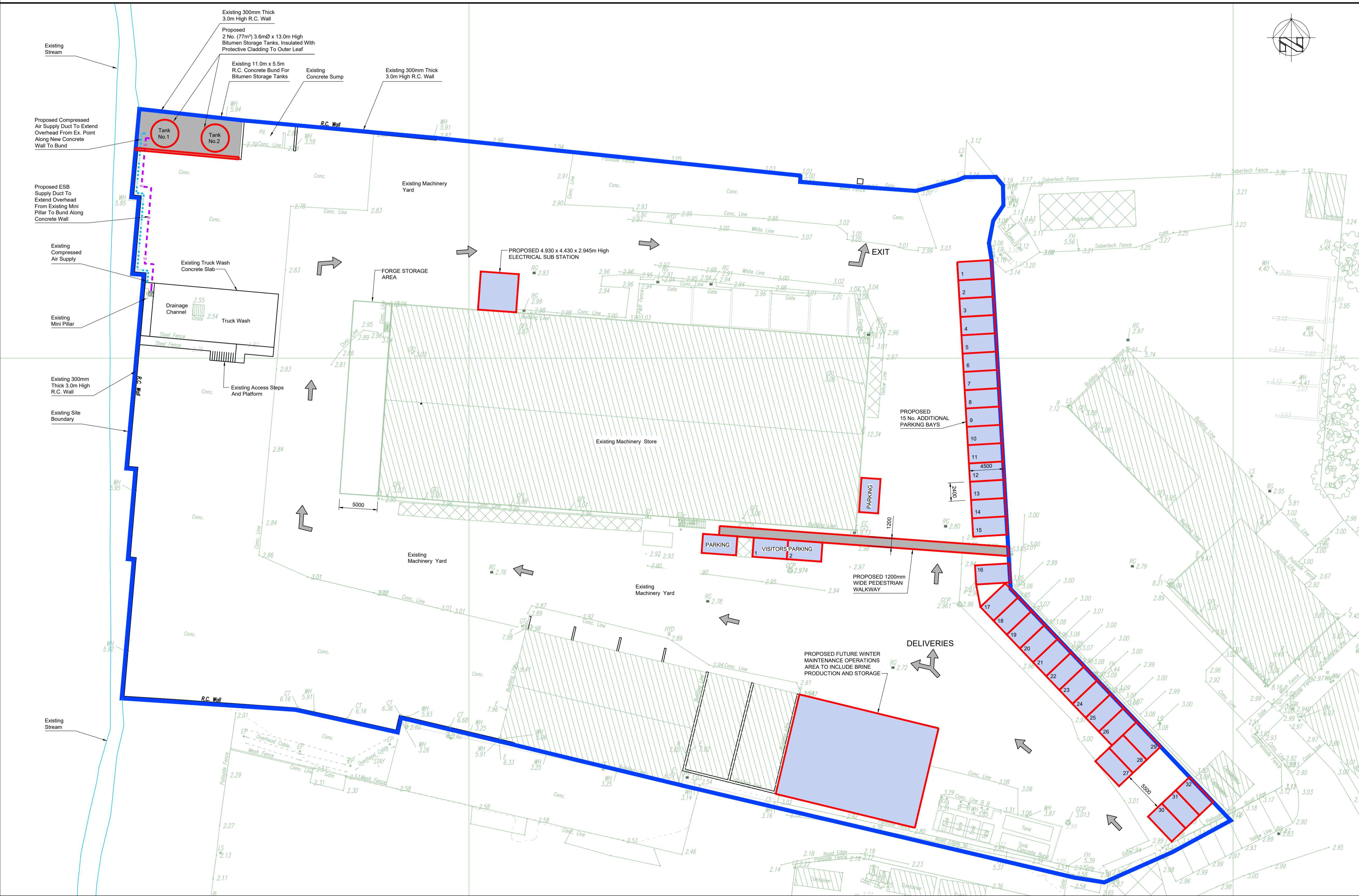

- Legend**
- Red line: Denotes Existing Site Boundary
 - Blue line: Denotes Proposed Works
 - Purple dashed line: Denotes Proposed ESB Supply Duct
 - Cyan dashed line: Denotes Proposed Compressed Air Supply Duct

- Reference Drawings**
- 17380-5001 Site Location Map And Existing Site Layout Plan

Rev.	Date	Description	by	chk'd	app.
B	03.07.2017	ISSUED FOR PART 8 PLANNING	FT	POD	POD
A	02.06.2017	ISSUED FOR PART 8 PLANNING	FT	POD	POD

Project: MACHINERY YARD OIL TANKS, DUNGARVAN, Co. WATERFORD

Title: PROPOSED SITE LAYOUT PLAN SHOWING PROPOSED WORKS

Client: WATERFORD CITY AND COUNTY COUNCIL

Malachy Walsh and Partners
Engineering and Environmental Consultants
Cork | Tralee | London | Limerick

Park House
Mahon Technology Park
Bessboro Road
Blackrock
Cork.

Tel : +353 (0)21 4536400
fax : +353 (0)21 4536450
E-mail : drawing@mwpl.ie

Drawn	BMP	FEB 2017	Drg. No.	Rev.
Ch'w(D.O.)	JD	FEB 2017	17380-5002	B
Ch'w(Eng.)	DC	FEB 2017		
Approved	POD	FEB 2017		