

NOTES

42 DOYLE STREET;
GROUND FLOOR (GFA)
EXTENSION = 12.12M²

43 DOYLE STREET;
GROUND FLOOR (GFA)
EXTENSION = 12.46M²

PART 8 PLANNING

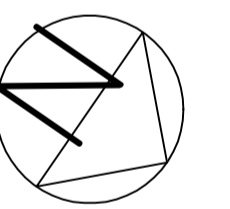

REVISION	DATE	INTLS	No.

IVAN GRIMES
DIRECTOR OF SERVICES - HOUSING,
COMMUNITY & EMERGENCY SERVICES

HOUSING

ADDRESS : Civic Offices, Balleys New Street, Waterford X91 XH42
TELEPHONE : 0761 - 102020
FAX NO. : 051 - 844708

PROJECT
**ACQUISITION / REFURBISHMENT
42 & 43 DOYLE'S ST, WATERFORD
for Waterford City & County Council**

TITLE
PROPOSED FLOOR PLANS

SCALE Stated	JOB No. 1152111C	DRAWING No. 103
DATE 25/09/2018	DRAWN BY MP	CHECKED BY

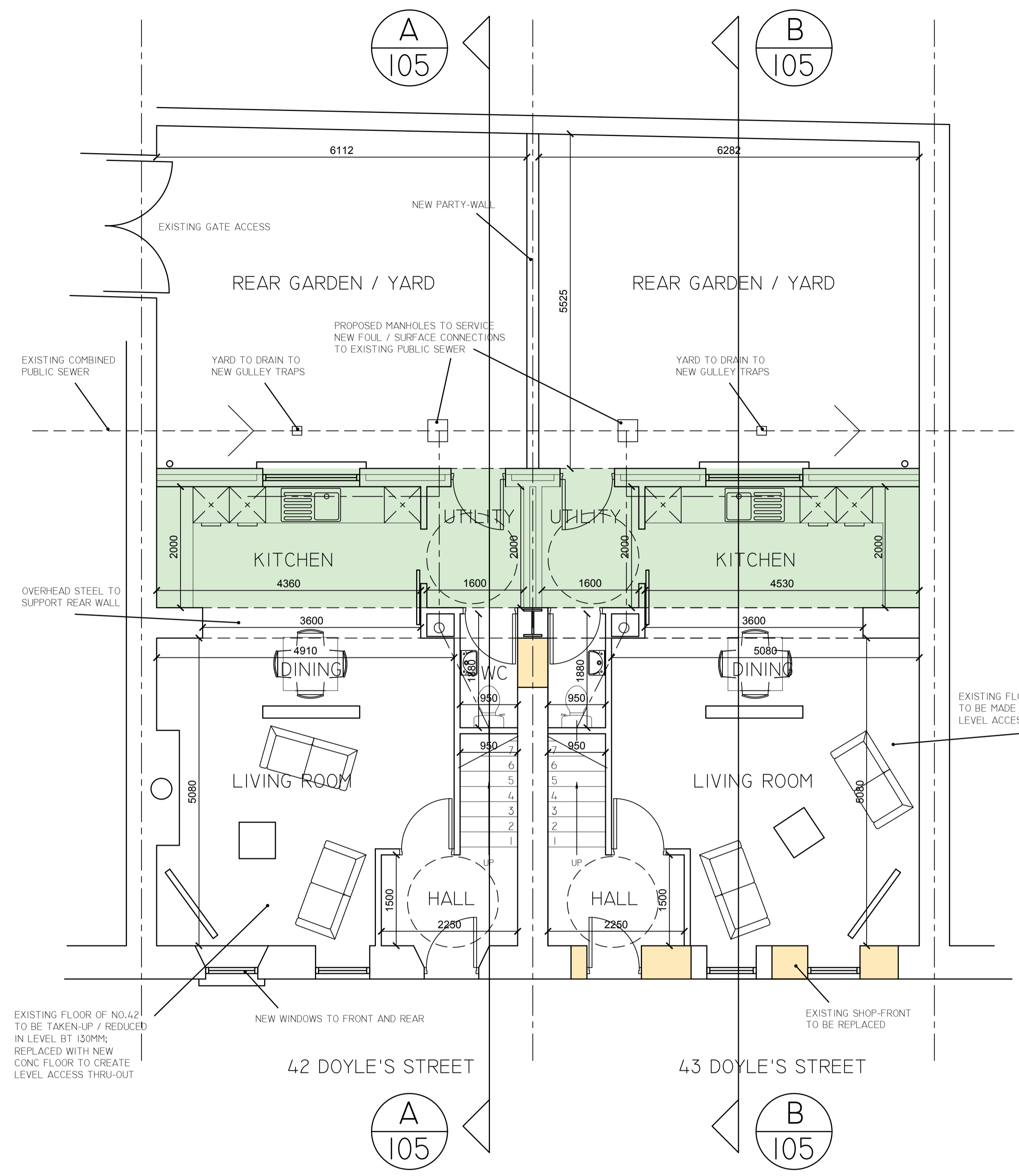

PROPOSED GROUND FLOOR PLAN
1:100 @ A3 / 1:50 @ A1

- PROPOSED NEW EXTENSION TO REAR
- PROPOSED NEW INFILL TO EXISTING STRUCTURE

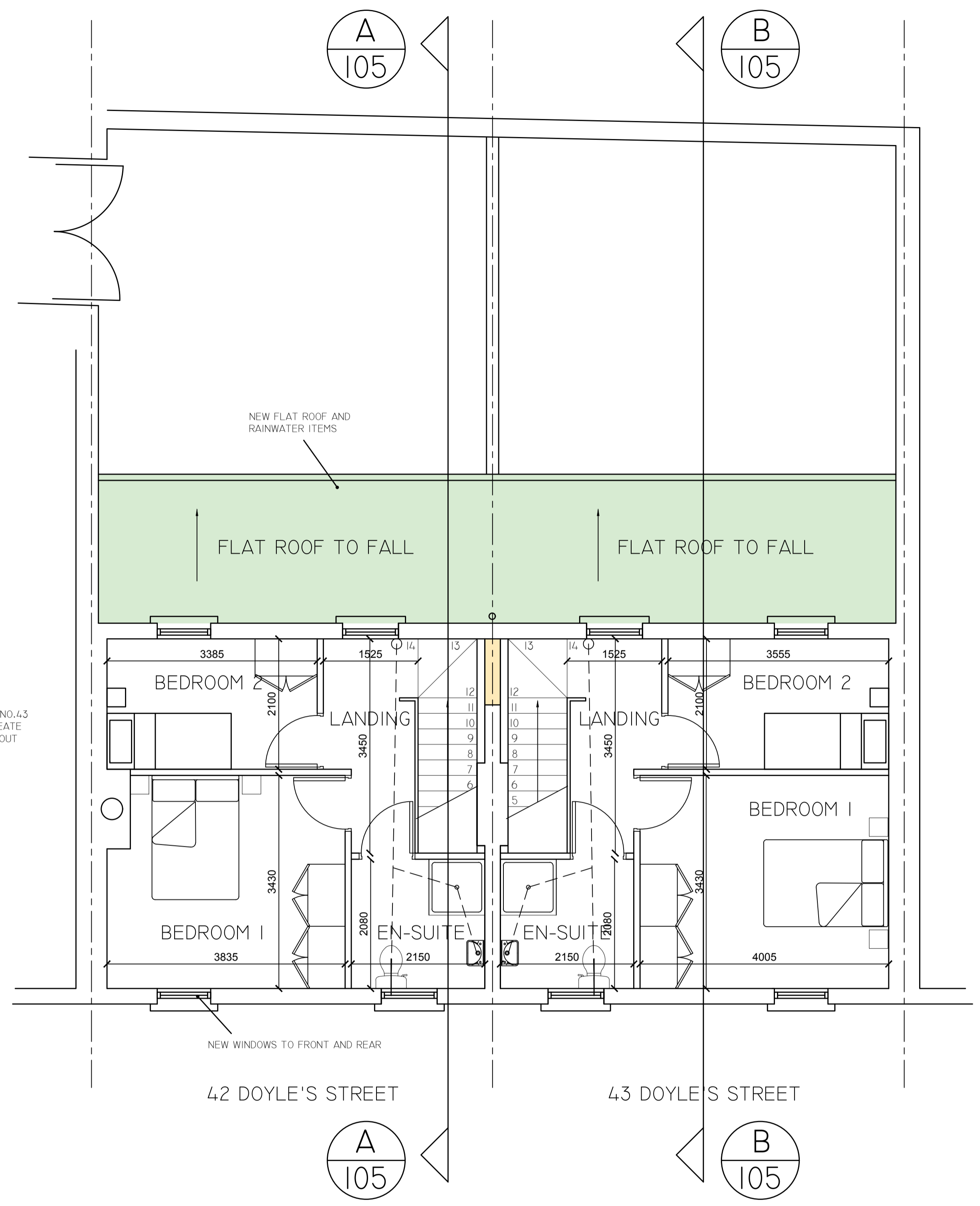

PROPOSED FIRST FLOOR PLAN
1:100 @ A3 / 1:50 @ A1